

NOTE: In all locations where electrical panels are shown in walls between suites or in corridor walls the fire separation shall be kept intact by furring out the wall for the recessed panel "inside" the drywall.

SUITE-2BR 514 Net Area: 966 sq ft SUITE-1BR+D 501 Net Area: 903 sq ft SUITE-1BR+D 502 Net Area: 804 sq ft SUITE-1BR+D 503 Net Area: 787 sq ft SUITE-2BR (A) 504 Net Area: 1209 sq ft

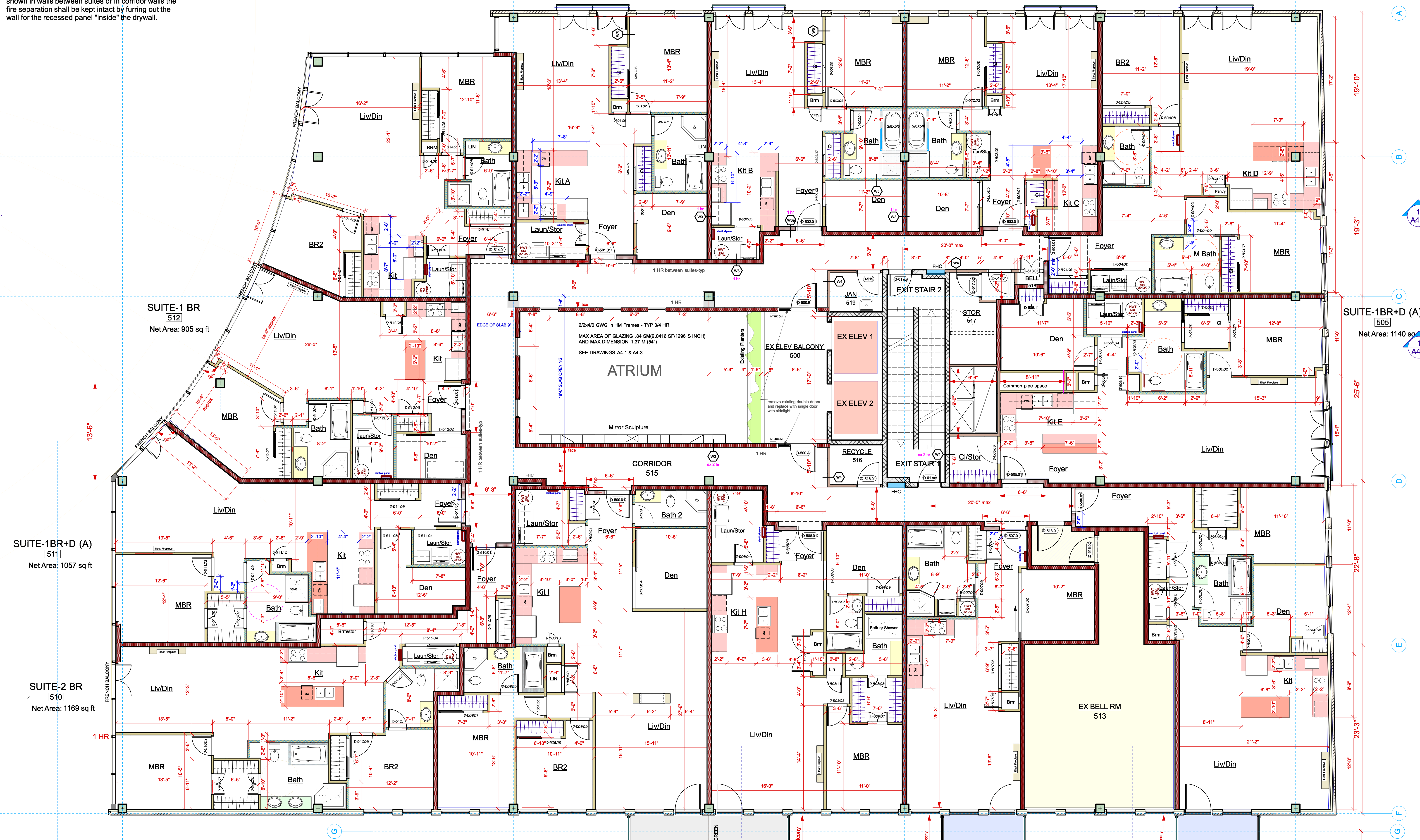

SUITE-1 BR 512 Net Area: 905 sq ft

SUITE-1BR+D (A) 511 Net Area: 1057 sq ft

SUITE-2 BR 510 Net Area: 1169 sq ft

SUITE-2BR+D+(B) 509 Net Area: 1384 sq ft

SUITE-1BR+D+(B) 508 Net Area: 1067 sq ft

SUITE-BACH 507 Net Area: 726 sq ft

SUITE-2BR+(B) 506 Net Area: 1070 sq ft

ATRIUM
22x410 GWG in HM Frames - TYP 3/4 HR
MAX AREA OF GLAZING: 84 SM (9.0416 SF/1296 S INCH)
AND MAX DIMENSION: 1.37 M (54")
SEE DRAWINGS A4.1 & A4.3

17,320 SF TOTAL AREA

1 5TH FLOOR PLAN
Scale: 1:72

No.	Date	Revision Notes
1	16-03	Permit 1

No.	Date	Issue Notes

Contractor shall check and verify all dimensions and conditions before commencing work. This drawing shall not be used for construction purposes unless counter signed by the Architect.

COUNTER SIGNATURE

BRIAN CLARK ARCHITECT
201 Cornwell Rd.
19111 Plover, ON, Canada M7B 2T0
(416) 347-4839 bclark@bclark.net

Owner: CENTURY VILLAGE
199 Front St, Belleville
Suite 118

Project Name: Century Village
Condominium
Development

Drawing Title: 5th Floor Plan
Residential

Drawn By: BWC Project ID: 1405
Reviewed By: Drawing No:

Date: May 16, 16 A-2.6
CAD File Name: of